

除非另有指定: 否則尺寸是以毫米為單位 表面加工: 公差: 線性: 角度:		加工處理:		去除毛邊 與銳角		不要縮放工程圖		修訂版 1	
姓名		簽名		日期		標題: <b>壓入式BB碗組</b>			
繪製者	Parkson			1021112		工程圖編號		BB869	
檢查者						材料:		A4	
核准者						重量:		比例:1:1	
製程						圖頁 1 OF 2			
品管									

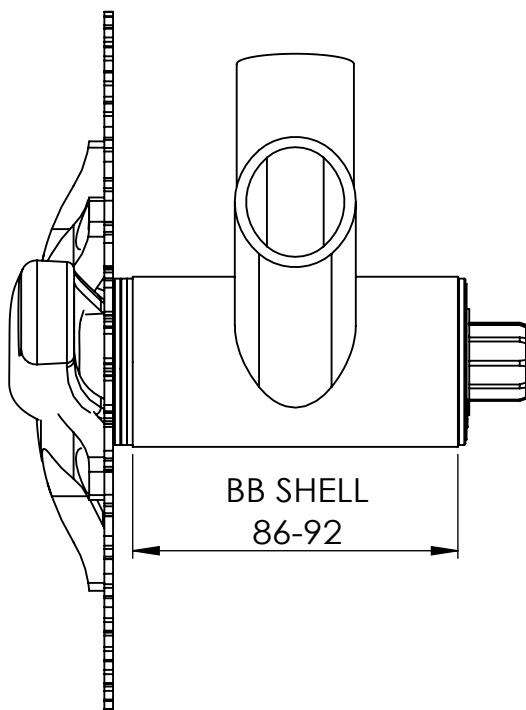
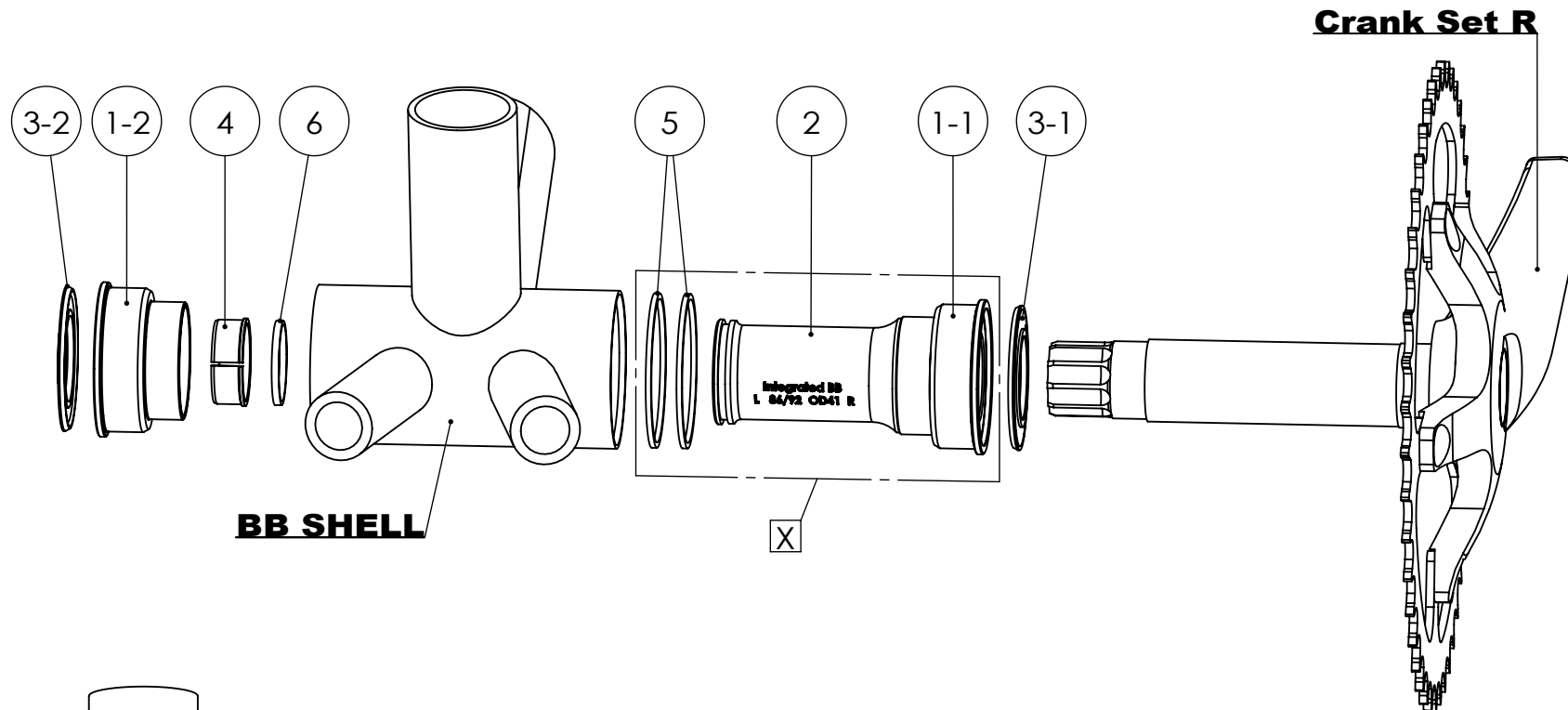

## YST BB-869

**Instruction: (Please refer to above drawing.)**

- 1. There are 7 items, total 9 parts in one package.**
- 2. Assemble #1-1 & 2 together. #2 should be R side.**
- 3. Put #5 into #1-1. #5 is optional for Chain Line adjustment.**
- 4. Install "X" into BB Shell by pressing.**
- 5. Install #3-1 and Crank Set R into "X".**
- 6. Put #6 through BB axle. #6 is optional to fill the gap between the end face of bearing and BB axle.**
- 7. Install #4 into #1-2BB then push it till stop to the end face of bearing.**  
**#4 is to convert bearing inner diameter from 24mm to 22mm.**
- 8. Install #1-2 into BB Shell by pressing.**
- 9. Put #3-2 through BB axle, Then tighten Crank with bolt.**